

REVISION RECORD				
REV	ECN	DESCRIPTION	DRFT	DATE

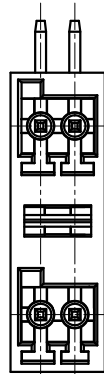

04P

More than 6P
the reinforcement

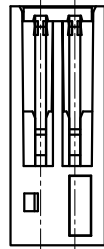
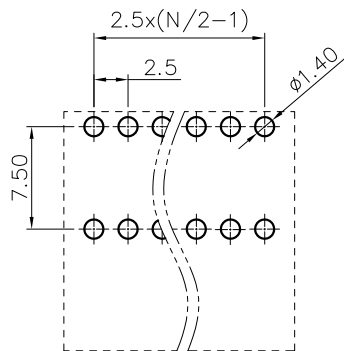
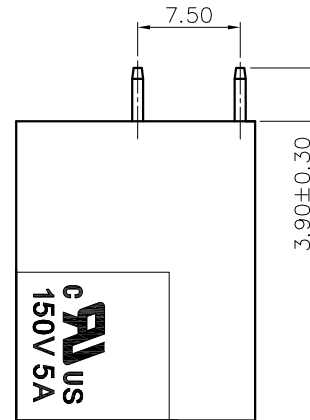
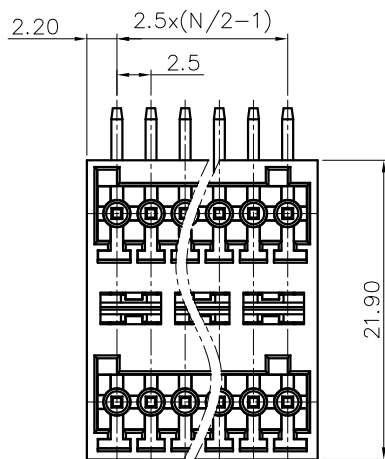
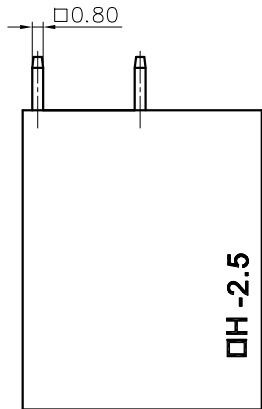
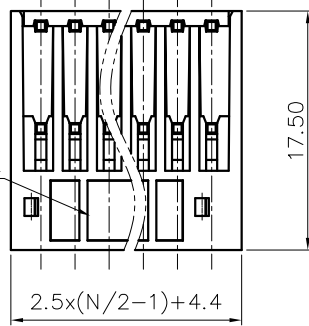

PCB LAYOUT

NOTES1:

UL Standard

1. Rated voltage/current : 150V / 5A
2. Withstanding voltage : AC1300V/1Min.

IEC Standard

1.

Pollution degree	2
Overtoltage category	II
Rate impulse voltage(KV)	2.5KV
Rate voltage(V)	100V
Rate current(A)	4A

NOTES2:

1. Dimension shall be interpreted per ASME Y14.5-2009
2. Pitch : 2.5mm, Poles : N=04~24P
3. Operating temperature: -40°C~+105°C
4. Undimensioned tolerances:

Pitch range in mm	Nominal dimension range in mm						0.1/10	
	Over 6 TO 10	Over 10 TO 24	Over 30 TO 60	Over 60 TO 100	Over 100 TO 150	Over 150		
±0.15	±0.20	±0.30	±0.30	±0.50	±0.70	±1.00	±1.30	±2*

5. RoHS Compliance

RH - 2.5 - XXP - 1Y - 00A (H)

(Series No.) (Pitch) (Poles) (Color): 1.(Grey)
2.(Blue)
3.(Black)
4.(Green)
5.(Orange)
6.(Red)
7.(Transparent)
8.(Yellow)
9.(White)

(RoHS)
00A-(Standard)

(Single Pitch)

DETACHED LISTS	PART NO.:			
	APPD: /	NAME: RH-2.5-XXP-1Y-00A(H)		
	CHKD: /			
	DRFT: /	TITLE: CUSTOMER DRAWING	REV	DO
	<p>THIRD ANGLE PROJECTION</p>	DRAWING NO.: /	SHEET	1/1
	MM (INCH)	DO NOT SCALE DRAWING	SCALE 1:1	