

REVISION RECORD

REV	ECN	DESCRIPTION	DRFT	DATE

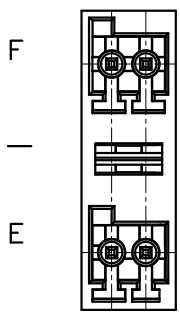

04P

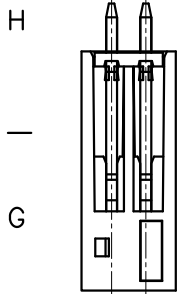
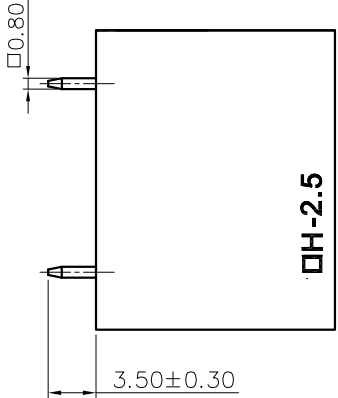

□H-2.5

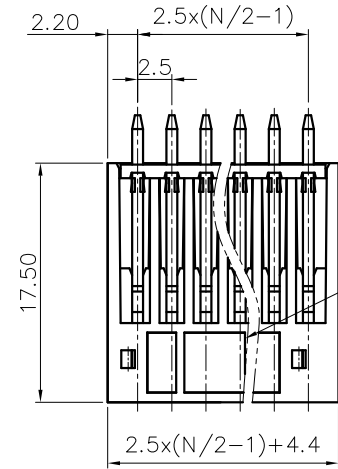

More than 6P the reinforcement

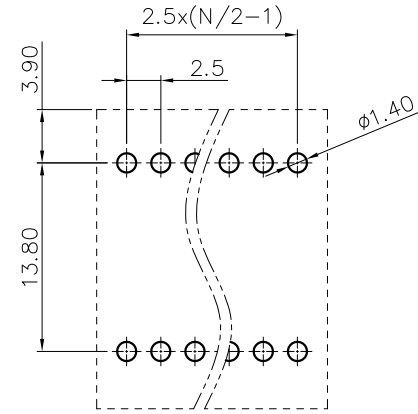
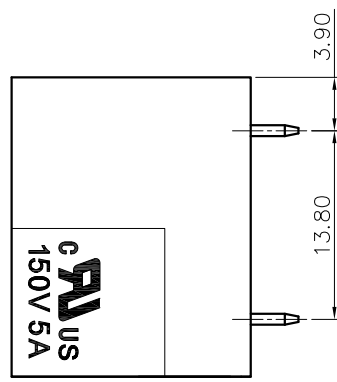
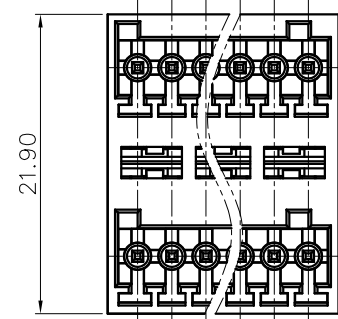

NOTES1:

- UL Standard
- 1.Rated voltage/current : 150V / 5A
- 2.Withstanding voltage : AC1300V/1Min.

IEC Standard

1. Pollution degree	2
Overvoltage category	II
Rate impulse voltage(KV)	2.5KV
Rate voltage(V)	100V
Rate current(A)	4A

NOTES2:

- 1.Dimension shall be interpreted per ASME Y14.5-2009
- 2.Pitch : 2.5mm, Poles : N=04~24P
- 3.Operating temperature: -40°C~+105°C
- 4.Undimensioned tolerances:

Pitch range in mm	Nominal dimension range in mm						0.1/10	
	Over 6 TO 6	Over 10 TO 10	Over 10 TO 24	Over 30 TO 30	Over 60 TO 60	Over 100 TO 100		Over 150 TO 150
±0.15	±0.20	±0.30	±0.30	±0.50	±0.70	±1.00	±1.30	±2*

5.RoHS Compliance

VH - 2.5 - XXP - 1Y - 00A (H)
 (Series No.) (Pitch) (Poles) (Color): 1.(Grey) 2.(Blue) 3.(Black) 4.(Green) 5.(Orange) 6.(Red) 7.(Transparent) 8.(Yellow) 9.(White)
 (Single Pitch) (RoHS) 00A--(Standard)

DETACHED LISTS	PART NO.:	/		
	APPD:	/	NAME:	VH-2.5-XXP-1Y-00A(H)
	CHKD:	/	TITLE:	CUSTOMER DRAWING
	DRFT:	/	REV	DO
	DRAWING NO.:		/	SHEET
THIRD ANGLE PROJECTION		MM (INCH)	DO NOT SCALE DRAWING	SCALE 1:1